

# DTMSS - Sendust Power Inductors



### APPLICATIONS:

- interference suppressing chokes (DC - 300kHz)
- energy storage inductors (DC - 300kHz)
- DC/DC converters
- SMPS
- EMI filters (DC - 1MHz)
- acoustic filters

### ORDERING CODE:

DTMSS - 58 / 0,68 / 6,0 - V

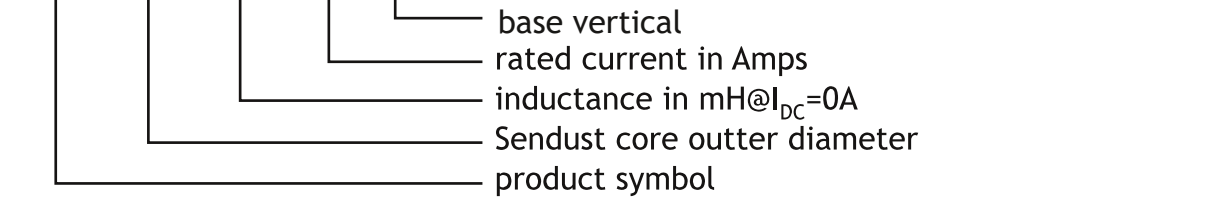

### DIMENSIONS:

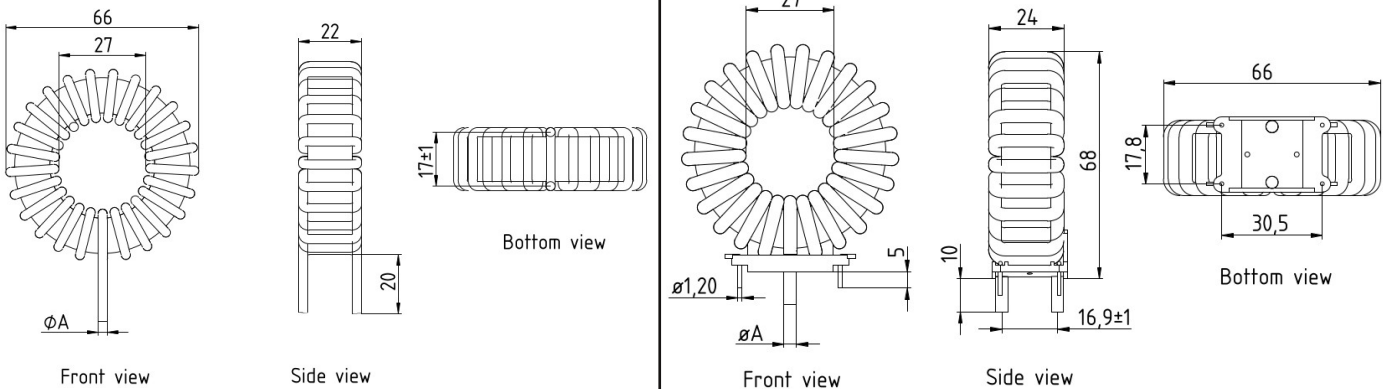

BV Version  
POD-35x22-V-4P

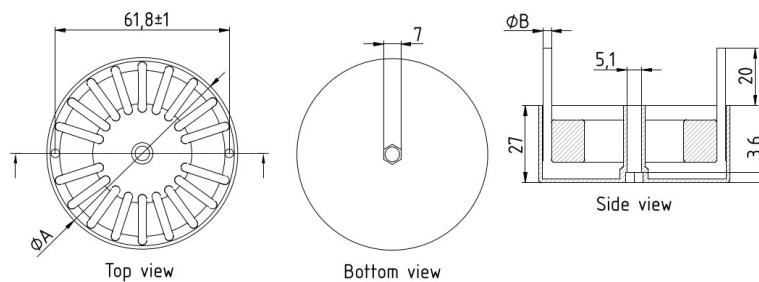

CH version  
OBUD-TOR-H-64x40

Dimensions				
Part number	V	BV	CH	
	$\Phi$ Amax [mm]	$\Phi$ Amax [mm]	$\Phi$ Amax [mm]	$\Phi$ Bmax [mm]
DTMSS-58/0,010/54	3,7	3,7	70	3,7
DTMSS-58/0,022/36	3,5	3,5	70	3,5
DTMSS-58/0,047/24	3,0	3,0	67	3,0
DTMSS-58/0,068/20	3,0	3,0	67	3,0
DTMSS-58/0,10/16	2,7	2,7	67	2,7
DTMSS-58/0,22/11	2,4	2,4	67	2,4
DTMSS-58/0,47/7,5	1,9	1,9	67	1,9
DTMSS-58/0,68/6,0	1,9	1,9	67	1,9

## ELECTRICAL PROPERTIES

Part number	$L_{nom}$ [ $\mu$ H]	$I_{nom}$ [A]	$L@I_{nom}$ [ $\mu$ H]	$R_{DC}$ [ $\Omega$ ]	$\Delta T@I_{nom}$ [ $^{\circ}$ C]*	
					V/BV	CH
DTMSS-58/0,010/54	10	54	7,82	0,0021	46	43
DTMSS-58/0,022/36	22	36	17,4	0,0042	36	31
DTMSS-58/0,047/24	47	24	38,3	0,0085	38	32
DTMSS-58/0,068/20	68	20	55,0	0,0140	49	38
DTMSS-58/0,10/16	100	16	80,4	0,0217	50	39
DTMSS-58/0,22/11	220	11	180	0,440	50	39
DTMSS-58/0,47/7,5	470	7,5	377	0,965	46	36
DTMSS-58/0,68/6,0	680	6,0	565	0,1435	49	39

\* winding losses only.

**CHARACTERISTICS:**

**Inductance graph DTMSS-58**

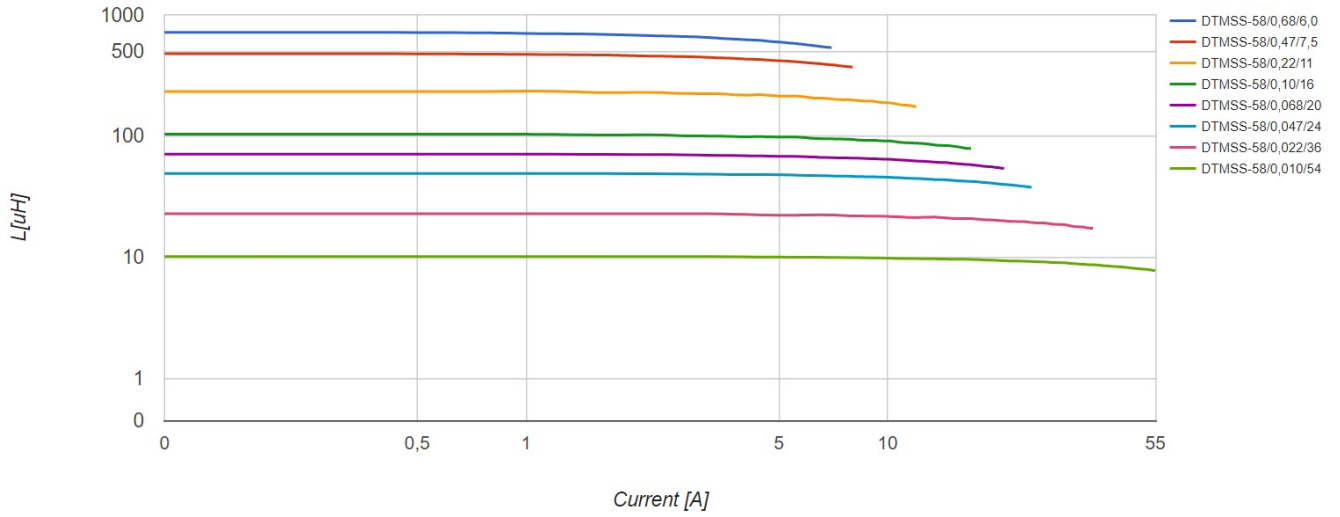

The measurement was made using a ed-k Power Choke Tester DPG10.

**Impedance graph DTMSS-58**

